



Actual picture of Purva Venezia

PURVA VENEZIA

Luxury apartments, Yelahanka
The spirit of Venice in Bangalore

OC No.: BDA/EM/T-676/11-12

COME HOME TO A TRULY INTERNATIONAL LIFESTYLE

Purva Venezia is inspired by the magical landscape of Venice. Whether it is the sparkling waterways, the arched bridges or the manicured gardens, the richness, colour, light and texture will leave you mesmerized.

Every aspect of this high-end home is thoughtfully designed - be it the vitrified flooring, the ornate lobby or even the water treatment plant. Your home will be so self-contained that you may never have to step out for days on end. A supermarket, a gym, a swimming pool, a health spa, a jacuzzi, a tennis court and many more amenities offer you a lifestyle that is truly unmatched.

If you've always believed in high quality living, it's time to put your beliefs into action. With a view of 1600 acres of greenery belonging to the University of Agricultural Sciences and an ideal location, Purva Venezia offers you a lifestyle that is too good to resist.



Actual picture of Purva Venezia

PURVA
VENEZIA
Luxury apartments, Yelahanka
The spirit of Venice in Bangalore

MASTER PLAN





AMENITIES

Entertainment Centre | Aerobics and Meditation Room | Card Room | Squash Court | Billiards Room | Table Tennis | Basketball Post | Badminton Court | Gymnasium | Steam & Sauna | Jacuzzi | Swimming Pool (Indoor and Outdoor) | Outdoor Children's Play Area | Tennis Court | Amphitheatre | Provision for Concierge | Provision for Restaurant | Provision for Cocktail Lounge | Provision for Supermarket | Provision for Health Care Centre | Provision for Launderette | Provision for Party Hall

PROJECT INCLUDES

Water Treatment Plant | State-of-the-art Fire Protection Systems | Meandering Water Course and Venetian Landscaped Garden | Well-lit and decorated Entrance Lobbies finished in Highly Polished Granite

The imagery used in the brochure is indicative of style only. The photographs of the interiors, surrounding views and location may have been digitally enhanced or altered and do not represent actual views or surrounding views. These photographs are indicative only.

PROJECT SPECIFICATIONS

STRUCTURE:

- RCC framed structure

LOBBY & STAIRCASE:

- Elegant ground floor lobby with highly polished granite/imported/Italian marble flooring

APARTMENT FLOORING:

- Vitrified tiles in living, dining, bedrooms, living and dining balcony, passages leading to bedrooms and attached balconies

KITCHEN & UTILITY:

- Vitrified tile flooring in kitchen and utility area
- Rectified/vitrified tile dado up to 2' ht roof above kitchen counter
- Highly polished granite for kitchen counter top
- Double bowl, single drain stainless steel sink with premium quality (Jaguar or equivalent) hot and cold basin mixer
- Provision for water purifier above the drain board

BATHROOMS:

- Anti skid/matt ceramic designer tile flooring
- Colored glazed designer tiles with designer border up to the false ceiling
- Master bathroom – Bathtub and granite/marble counter-top wash basin (Jaguar or equivalent brand) with bottle trap
- Other bathrooms – Shower area with ledge, wash basin with pedestal
- All bathrooms will have good quality vitreous pastel colored wall mounted EWC (button type) with premium quality (Jaguar or equivalent brand) CP fittings and sanitary fixtures

DOORS:

- Main door – Engineered door with sufficient thickness to in house good quality hardware with security eye
- Bedroom doors and bathroom doors – Engineered door with good quality hardware
- Balconies for living and dining – Glazed French UPVC windows
- Other balconies and utility door-Glazed door and window with UPVC frames with sliding shutters

WINDOWS:

- UPVC frames with glazed, sliding/hinged shutters with mosquito mesh

VENTILATORS

- UPVC with glazed, louvered/hinged ventilators
- Provision for exhaust fan

PAINTING:

- Acrylic based paint and textures surfaces in selective places as per design for exterior fascia of the building
- Interior walls are painted in oil bound distemper

BALCONY RAILINGS:

- Ornamental railings as per architect's design

CEILINGS:

- Cornices in living, dining, foyer and in passage areas

STAIR HANDRAILS:

- Railings as per architect's design

ELECTRICAL:

- All electrical wiring is concealed with premium quality PVC conduits
- Adequate power outlets for lights, fans, exhaust-fans, call-bell, television and telephone points are provided in the apartment
- Two AC points in master bedroom and guest bedroom
- Telephone and television points in living area and all bedrooms and provision for cable TV connection
- Internet connectivity in all bedrooms
- 7 KW power will be provided for 3 BHK, 5 KW power for 2 BHK.

ELEVATORS

- Hi-speed automatic passenger lifts are provided in each block with intercom facility connected to security cabin

D G POWER:

- Back-up for common area lighting, pumps and lifts.
- 3 KW of D.G. power backup is provided for 3 BHK, 2 KW for 2 BHK

INTRA COMMUNICATION SYSTEM:

- Intra-communication facility from apartment to apartment and to security cabin within the complex

VISITOR CAR PARK:

- Ample visitor car parking available

UNIT PLANS



2 BHK
Type A - 1322 sq. ft.



3 BHK
Type C - 1610 sq. ft.

- 2 BED ROOM UNIT (TYPE A) 1322 SFT.
- 2 BED ROOM UNIT (TYPE B) 1327 SFT.
- 3 BED ROOM UNIT (TYPE C) 1610 SFT.
- 3 BED ROOM UNIT (TYPE D) 1614 SFT.
- 3 BED ROOM UNIT (TYPE E) 1780 SFT.

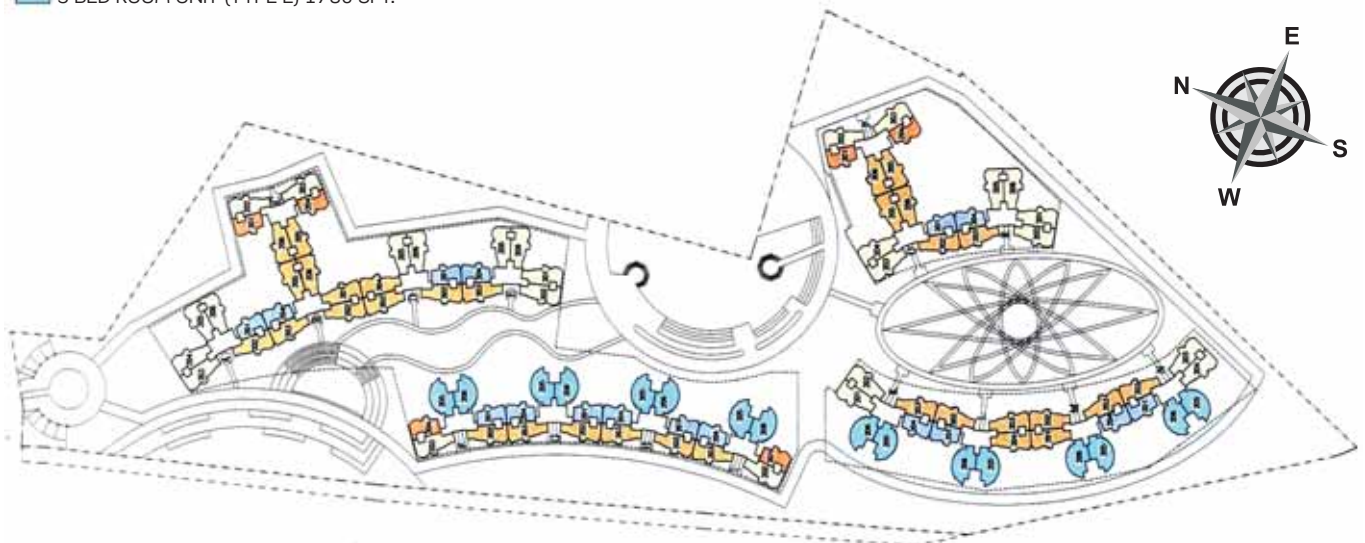

LOCATION MAP

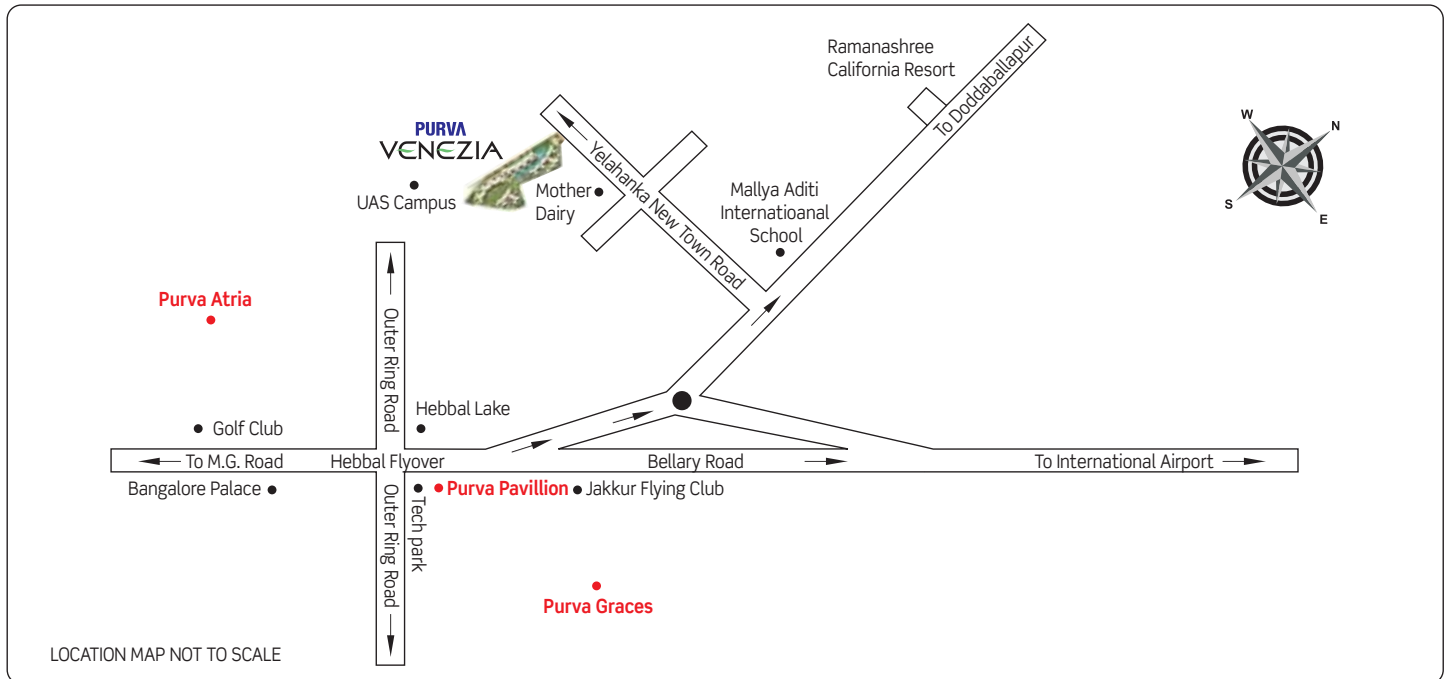

PROXIMITY TO PURVA VENEZIA

5 kms from Yelahanka Railway Station | 5 kms from proposed Peripheral Ring Road | 10 kms from Hebbal Flyover | 18 kms from Bengaluru International Airport | 20 kms from Majestic Railway Station

IN YOUR NEIGHBOURHOOD

Nearby Hospitals

Columbia Asia Hospital | Cauvery Medical Centre | Bangalore Baptist Hospital | Dr. Agarwal's Eye Hospital

Nearby Schools

Mallya Aditi International School | Ryan International School | Vidyashilp Academy | Delhi Public School | Canadian International School | TRIO World School | NITTE International School

Nearby Colleges

NITTE Meenakshi Institute of Technology | BMS Institute of Technology | Seshadripuram PU College | Reva Institute of Technology and Management | Sir M Visvesvaraya Institute of Technology

Nearby Shopping Centres and Restaurants

Esteem Mall | Big Bazaar | Food World | Reliance Fresh | More | Spencer's | Domino's | Pizza Corner | Shanthi Sagar | Cafe Coffee Day

Nearby Clubs and Resorts

The Country Club | Ramanashree California Resort | Angsana Oasis Spa & Resorts | Silver Oak Resort | Fantasy Golf Resort | Chairman's Club & Resort

PURAVANKARA®

Puravankara Limited,

130/1, Ulsoor Road, Bangalore - 560042

Site: Survey No. 5/2, Mandalakunte Village, GKVK post,
Yelahanka Hobli, Bangalore North Taluk - 560 064.

Call: +91 80 44 555 555 / 1860 208 0000

www.puravankara.com | sales@puravankara.com

CHENNAI: Ph - +91- 44- 44 55 55 55

COIMBATORE: Ph - +91- 422- 44 55 55 55

KOCHI: Ph - +91- 484- 44 55 55 55

DUBAI: Ph - 800035703370 (Toll free)





READY-TO-MOVE-IN PROJECTS ACROSS INDIA

Purva Highland, Off Kanakapura Road, Bangalore
Purva Season, C.V. Raman Nagar, Bangalore
Purva 270 Degrees, C.V. Raman Nagar, Bangalore
Purva Skywood, Off Sarjapur Road, Bangalore
Purva Platina, RMV IInd Stage, Bangalore
Purva Whitehall, Sarjapur Main Road, Bangalore
Purva Midtown Residences, Off Old Madras Road, Bangalore
Purva Venezia, Yelahanka, Bangalore
Purva Atria, RMV IInd Stage, Bangalore
Purva Oceana, Marine Drive, Kochi
Purva GrandBay, Marine Drive, Kochi
Purva Eternity, Kakkanad, Kochi
Sky Condos Series I at Eternity, Kochi
Purva Swanlake, OMR, Chennai
Manhattan Condos, Pallikaranai, Chennai
Purva Bluemont, Singanallur, Trichy Road, Coimbatore

ON-GOING PROJECTS ACROSS INDIA

Purva Palm Beach, Off Hennur Road, Bangalore
(RERA No.: PRM/KA/RERA/1251/446/PR/170907/000091
RERA Website: <https://rera.karnataka.gov.in/>)
Purva Skydale, Off Sarjapur Road, Bangalore
Purva Westend, Hosur Road, Bangalore
(RERA No.: PRM/KA/RERA/1251/310/PR/170915/000236
PRM/KA/RERA/1251/310/PR/170915/000394
RERA Website: <https://rera.karnataka.gov.in/>)
The Sound of Water, Off Bannerghatta Road, Bangalore
(RERA No.: PRM/KA/RERA/1251/310/PR/170916/000230
RERA Website: <https://rera.karnataka.gov.in/>)
Coronation Square, J. P. Nagar, Bangalore
(RERA No.: PRM/KA/RERA/1251/310/PR/170916/000235
RERA Website: <https://rera.karnataka.gov.in/>)
Purva Windermere, Pallikaranai, Chennai
Purva Amaiti, Singanallur, Trichy Road, Coimbatore
Purva Silversands, Mundhwa, Pune
(MahaRERA No.: P52100005377 (Building 1), P52100007566 (Building 4-9)
MahaRERA Website: <https://maharera.mahaonline.gov.in>)

Purva Venezia is financed by Trustee Partner: IL&FS Trust
Company Limited. Loans available from all leading banks.

The images used are only indicative    

Changes may be made during the development and standard fittings and specifications are subject to change without notice. Standard fittings and finishes are subject to availability and vendor discretion. Fittings, finishes and fixtures shown in the images contained in this brochure are not standard and will not be provided as part of an apartment. The information contained herein is believed to be correct but is not guaranteed. Prospective purchasers should make and must rely on their own enquiries. The colours of the buildings are indicative only. This brochure is a guide only and does not constitute an offer or contract.